



**YAMAHA**

# RD

**250 LC/350 LC**

## **UPPER & LOWER FAIRING** **Fitting Instructions**

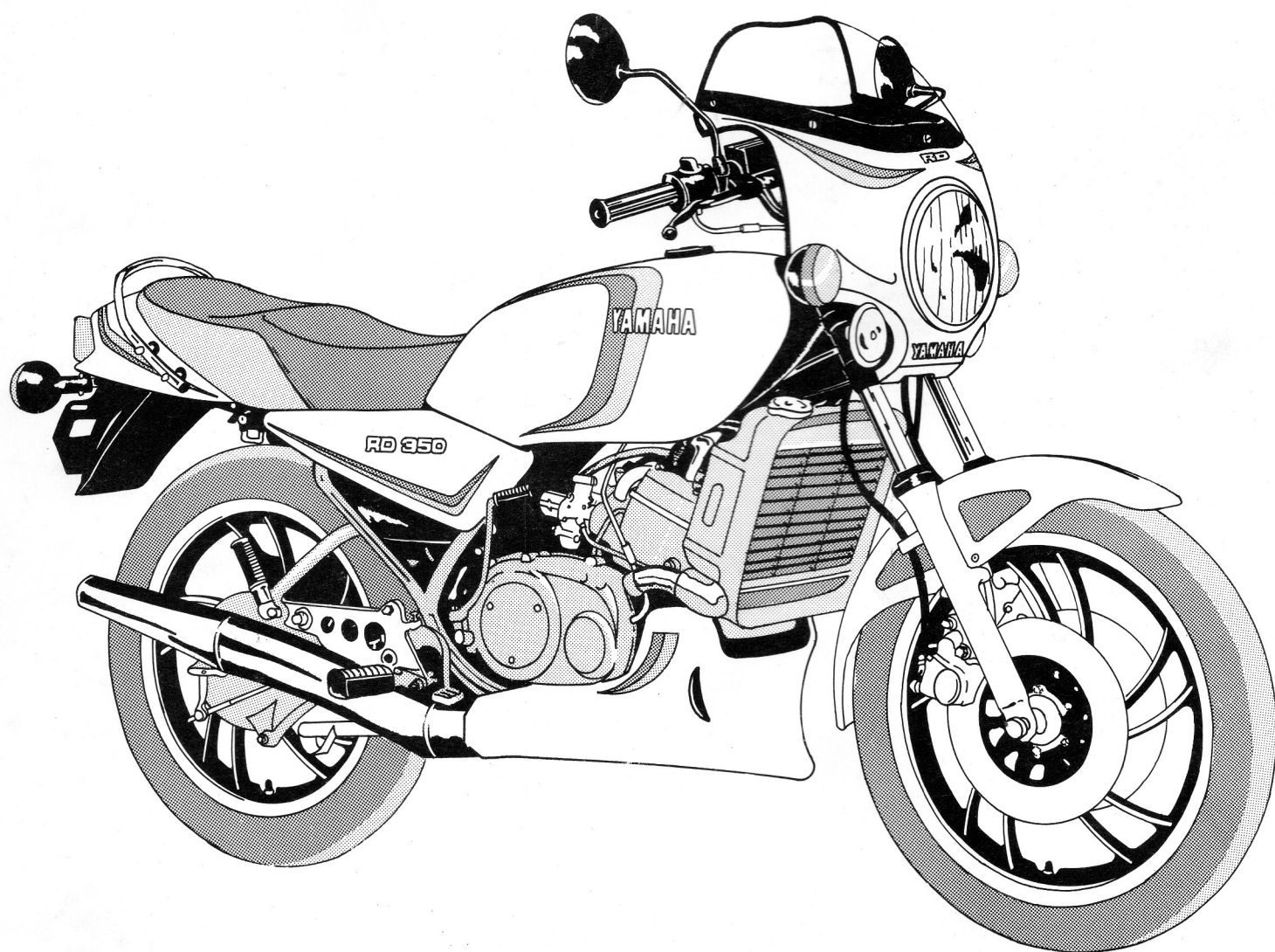



# YAMAHA

INSET 4

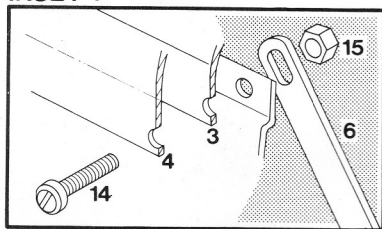

Dia.1.

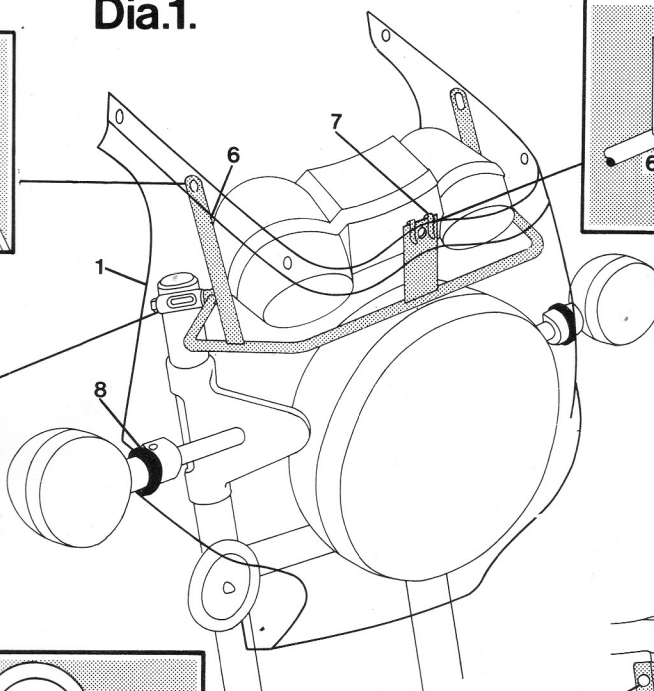

INSET 3

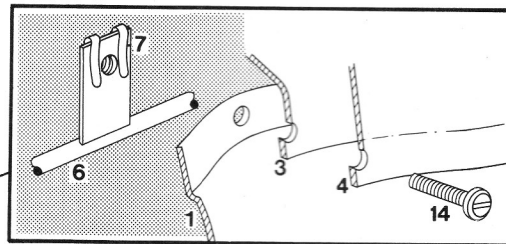

INSET 1

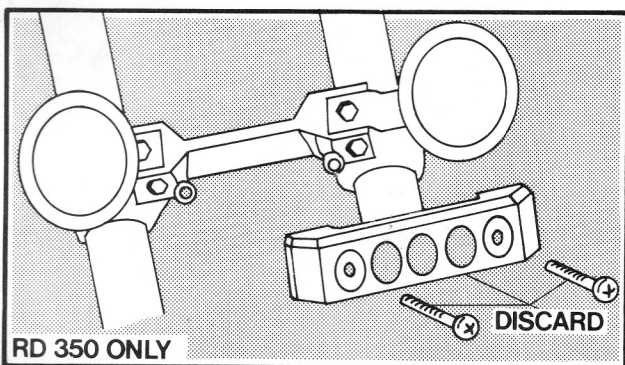
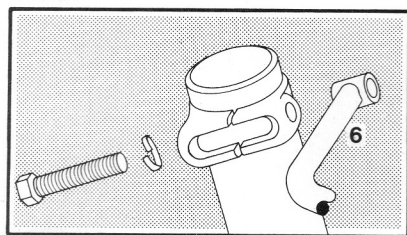

INSET 2

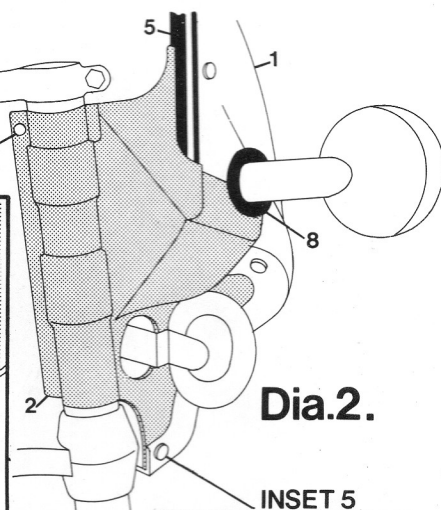
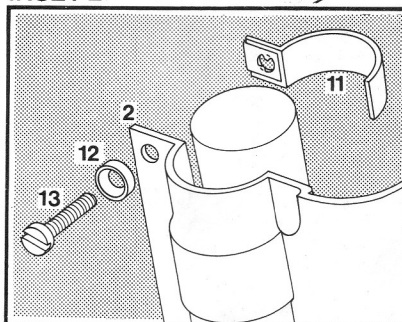

Dia.2.

INSET 5

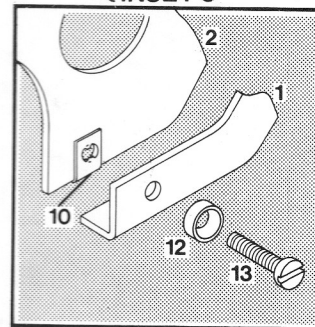

Dia.3.

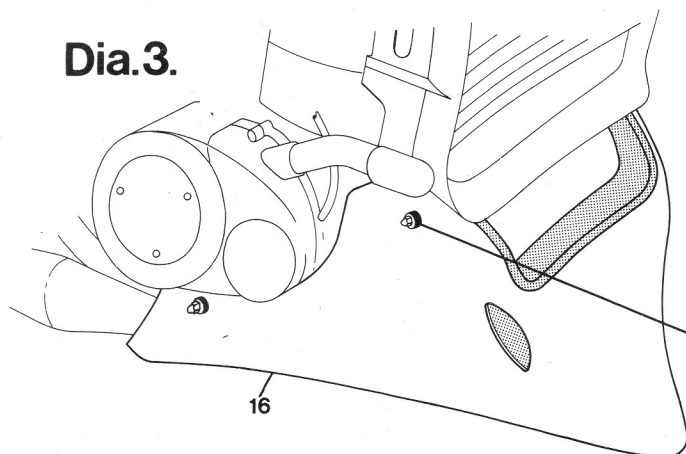

INSET 6

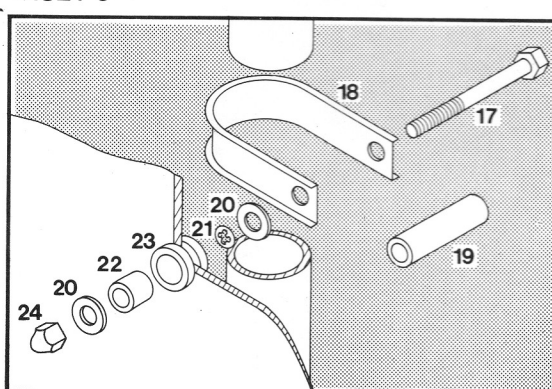

## RD 250LC/350LC UPPER AND LOWER FAIRING FITTING INSTRUCTIONS

### UPPER FAIRING

- (1) Read fitting instructions. Check and identify all parts.
- (2) **RD 350 LC only**, disconnect and remove horns. Remove plastic trim from horn bracket.
- (3) Remove top fork yoke bolts and discard nuts. Fit fairing support bracket (6) using existing bolts and spring washers. See dia.1 and inset 1. **'Finger' tighten only.**
- (4) Fit split grommets (8) around indicator stems. See dia.1.
- (5) **RD 350LC only**, remove blind grommets (9) from side panels (2). Fit captive nuts (10) to side panels around pre-drilled holes (3 per panel). See inset 5.
- (6) Position and secure side panels (2) using top fork clamps (11) plastic washers (12) and self tapping screws (13). See dia.2. and inset 2. **Do not tighten. RD 350LC only**, pull horn wires through horn bracket apertures, fit horns and reconnect wires.
- (7) Position fairing in split grommets and locate on support bracket with plastic nuts and bolts provided, (14 and 15) locate central bolt first, see dia.1. and inset 3. Then locate and secure the two side fixings, see inset 4. **Do not tighten.**
- (8) Fit side panels to fairing using plastic washers (12) and self tapping screws (13). **Do not tighten.** See inset 5.
- (9) Adjust position of fairing if necessary then tighten all fittings. First tighten top fork yoke bolts, then the three plastic nuts and bolts, finally tighten all side panel fixings.

### LOWER FAIRING

- (1) Push nylon spacers (22) into rubber grommets (23) already fitted to the lower fairing.
- (2) Fit one 'U' clamp assembly (see inset 6) on each frame down-tube just below the radiator. Fit the third assembly just forward of the side stand and the fourth assembly in a similar position but to the rear of the strengthening collar on the opposite frame tube. Parts 17, 18, 19, 20 and 21. **It is advisable at this point to tighten all assemblies to pre-form the clamps around frame tubes.** Ensure that in each case the bolt and plain washer are held firmly in place by the push-on fix washer (21) and that the bolt head is properly captivated within the channel on the 'U' clamp.
- (3) Position lower fairing onto 'U' clamp assemblies. It may be necessary to slide the 'U' clamp assemblies up or down the frame tubes to achieve proper alignment. Secure using parts 20 and 24. **'Finger' tighten only.** See dia.3 and inset 6.
- (4) Adjust position of lower fairing if necessary and ensure that there is suitable working clearance on side stand spring and exhaust system. Tighten all fittings.

## YAMAHA RD 250LC/350LC UPPER AND LOWER FAIRING PARTS LIST

Item No.	No. Off	Description
1	1	Upper fairing.
2	2	Side panel (left and right hand).
3	1	Console (fitted).
4	1	Screen (fitted).
5	1	Edge trim.
6	1	Fairing support bracket.
7	1	6mm Captive nut.
8	2	Split grommet 45mmx 11mm.
9	2	Blind grommet 43mmx 7mm.
10	6	Captive nut.
11	2	Top fork clamp (captive nut fitted).
12	8	Plastic cup washer.
13	8	Self tapping screw.
14	7	6mmx20mm plastic bolts (4 fitted).
15	6	6mm Plastic nuts (4 fitted).
16	1	Lower fairing.
17	4	6mmx1mmx50mm Hex. bolt.
18	4	'U' clamps.
19	4	6mmx22mm Lg. spacer.
20	8	6mmx19mm washer.
21	4	6mm push-on fix washer.
22	4	6mmx10mm Lg. nylon spacer.
23	4	Rubber grommet (fitted).
24	4	6mm Dome nut.

**Yamaha reserve the right to alter the specification without notice.**

**RD 250LC/350LC  
UPPER AND LOWER FAIRING  
SPARES LIST**

Part No.	Description	Item No.	No. Off	Remarks
BSP 104	Screen	4	1	Perspex 504
BSP 105	Console	3	1	
BSP 106	Upper fairing	1	1	Red decals
BSP 107	Upper fairing	1	1	Blue decals
BSP 108	Upper fairing	1	1	Black
BSP 109	Fairing support bracket	6	1	
BSP 110	Side panel inc. Captive nut	2 & 10	1 set	Left and right
BSP 111	Fitting kit comprising:	—	1 set	
	6mm captive nut	7	1	
	Split grommet 45mmx11mm	8	2	
	Blind grommet 43mmx7mm	9	2	
	Captive nut	10	6	
	Top fork clamp			
	(captive nut fitted)	11	2	
	Plastic cup washer	12	8	
	Self tapping screw	13	8	
	6mmx20mm plastic bolt	14	7	
	6mm plastic nut	15	6	
	6mmx1mmx50mm Hex. bolt	17	4	
	'U' clamps	18	4	
	6mmx22mm Lg. spacer	19	4	
	6mm x 19mm washer	20	8	
	6mm push-on fix washer	21	4	
	6mmx10mm Lg. nylon spacer	22	4	
	6mm dome nut	24	4	
BSP 112	Lower fairing inc. Grommet	16 & 23	1 & 4 resp.	Red decals
BSP 113	Lower fairing inc. Grommet	16 & 23	1 & 4 resp.	Blue decals
BSP 114	Lower fairing inc. Grommet	16 & 23	1 & 4 resp.	Black

**BREALEY SMITH (NOTTM) LTD.  
Great Britain.**